

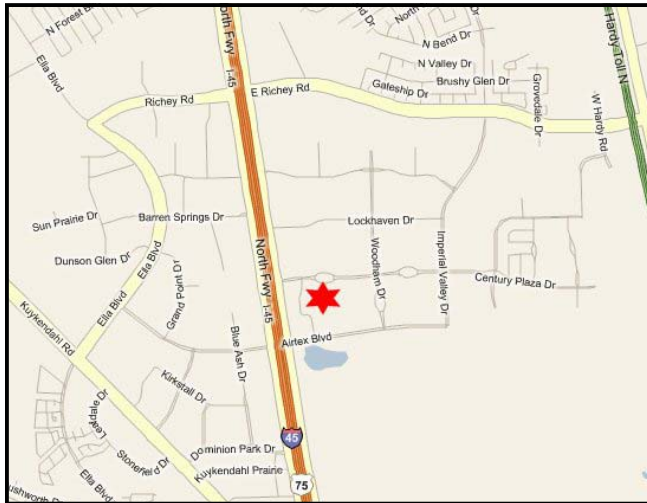

Al Lum Properties



350 Century Plaza Drive 24.72 acres

Frontage on 3 streets with one 21,752 sf masonry/metal building with 30' open ceilings in 60' x 100' center and some offices; a 6,925 sf masonry/metal building with offices and reception area. Seller will divide. **Shown by appointment only.**

- Approximate frontages:
1663' Century Plaza Drive
760' Edge Park Circle
627' Woodham Drive
- All Utilities (MUD 36)
- Not in flood plain
- Tax rate \$2.86 (2006)
- Km page 372C
- Asking \$6.1 million

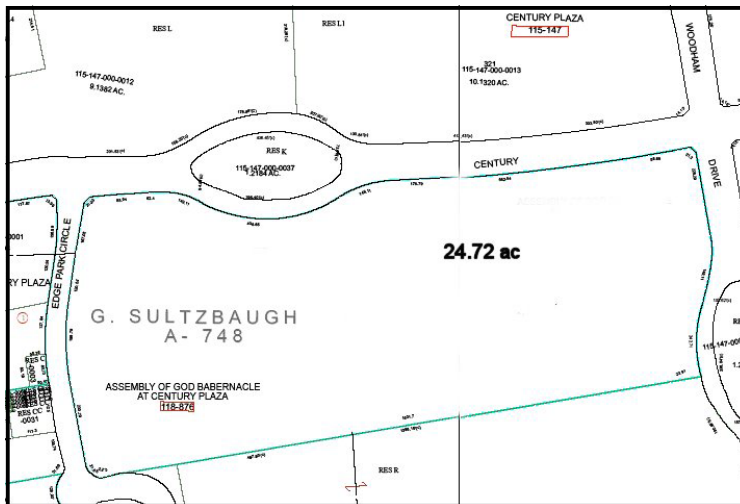

**Contact Rebecca Lum
281-821-2020**

Al Lum Properties, Inc.
P O Box 682825 Houston, Texas 77268-2825
281.821.2020 Fax:281.821.0100
www.allumproperties.com

The information above is believed to be true and reliable, but no warranty or representation, express or implied, is made as to its accuracy. This information is submitted subject to errors, omissions, change of price, rental or other conditions, withdrawal without notice, and to any listing conditions imposed by our principles.