

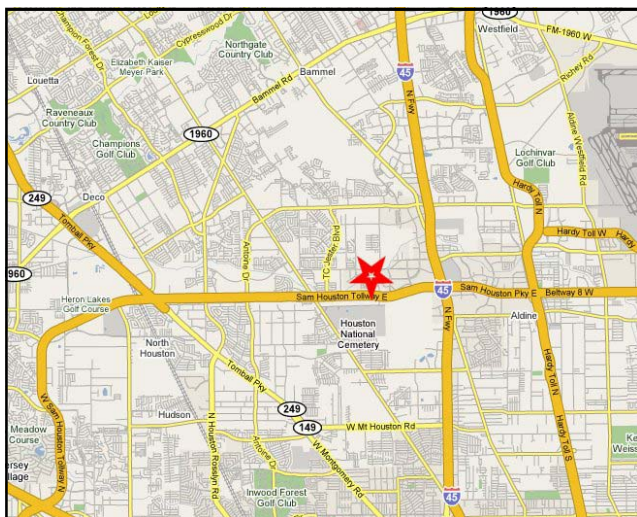

Al Lum Properties



2.4660 +/- Acres
Beltway 8/Ella Area

Great site just off Beltway 8 between Ella and T.C. Jester. This portion of Beltway 8 has seen a lot of "industrial use" construction this past year including new construction next door to this tract.

- 156.5' fronting Sharmon X
635.4' deep (HCAD)
- Not currently in MUD
- Not in flood plain
- 2007 Tax rate \$2.37
- Km page 372T
- Asking \$3.65/sf

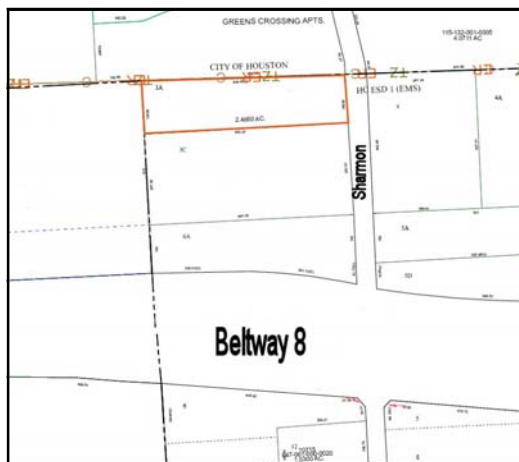

Contact Rebecca Lum
Or Marissa Masterson
281-821-2020

Al Lum Properties, Inc.
P O Box 682825 Houston, Texas 77268-2825
281.821.2020 Fax:281.821.0100
www.allumproperties.com

The information above is believed to be true and reliable, but no warranty or representation, express or implied, is made as to its accuracy. This information is submitted subject to errors, omissions, change of price, rental or other conditions, withdrawal without notice, and to any listing conditions imposed by our principles.